

KING'S HALL



VENDOR BROCHURE

2025



BEACON HALL, HERNE BAY
WWW.THEKINGSHALL.COM

CONTENTS

03

WELCOME TO THE KING'S HALL



04

EXPLORE THE KING'S HALL



07

FLOOR PLANS & LAYOUTS



13

TECHNICAL SPECIFICATION



17

HIRE CHARGES



19

BOOKING FORM



19

TERMS & CONDITIONS



DISCOVER THE PERFECT VENUE: **THE KINGS HALL**

Thank you for considering The Kings Hall for your upcoming event. Our venue caters to both community and professional groups, providing a unique and versatile space that is perfect for a wide range of functions and events.

THE KINGS HALL BOASTS:

- A welcoming foyer
- A spacious main hall
- A fully stocked bar
- Five dressing rooms
- A fully equipped stage
- A charming rooftop bandstand

We highly recommend booking a tour to fully appreciate the flexibility and distinctive charm of our venue.



THE KINGS HALL SETTING & VIEW

The Kings Hall, Herne Bay enjoys a picturesque location on the Kent coast, offering stunning views and a charming atmosphere that enhances any visitor's experience. Situated on the seafront, the venue provides uninterrupted vistas of the sea, making it a scenic backdrop for events and gatherings.

Surrounded by the quaint seaside town of Herne Bay, The Kings Hall benefits from a vibrant local community and easy access to amenities. Its location near the beach adds to its appeal, offering visitors the chance to enjoy leisurely walks along the promenade or relax on the sandy shores. The town itself boasts a mix of historical landmarks, shops, cafes, and restaurants, creating a welcoming environment for both residents and visitors alike.

The Kings Hall's setting complements its role as a cultural hub, where music performances, dances, community events, and more take place against the backdrop of Herne Bay's natural beauty. Whether attending an event or simply enjoying the surroundings, The Kings Hall in Herne Bay offers a memorable experience enriched by its coastal location and scenic views.

The Kings Hall, over a century old and located just a stone's throw from the sea, has limited parking facilities on-site. While we provide parking for four disabled badges and accommodate staff and event trucks, customer parking is available on Beacon Hill road, or the local car parks.

**STOP BY, AND ENJOY THE
BEST VIEW IN HERNE BAY!**

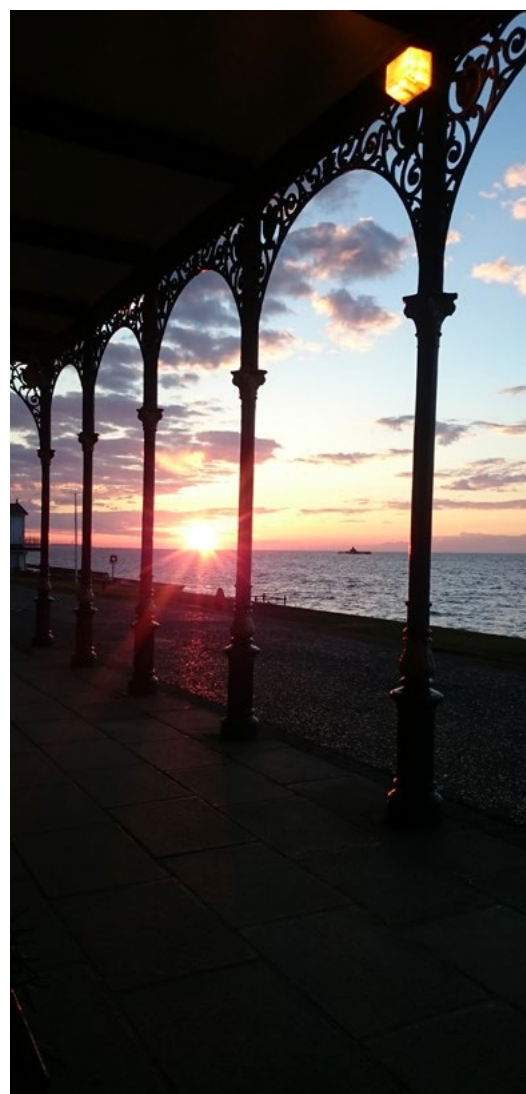

THE FOYER & CAFÉ

We are thrilled to partner with Scoops at The Kings Hall. Situated independently in the venue's foyer, Scoops welcomes guests seven days a week from 9am to 4pm. It offers a warm and inviting environment for customers, dog walkers, beachgoers, and local residents to enjoy coffee and ice cream.

Well-behaved dogs on a lead are welcome inside the foyer and in the Scoops café area. Please note that the foyer is not available for standard hire, and we kindly ask all hiring companies to respect the Scoops café area, which operates independently of any hire agreements.

For more details about Scoops, please visit their website or contact them directly at 01227 230575.

THE BAR

The Kings Hall Bar offers more than just drinks; it provides an exceptional experience with its stunning views. Positioned to offer the best view in Herne Bay, guests can enjoy uninterrupted vistas of the sea and breathtaking sunsets.

Inside, the bar features a diverse selection of beverages and snacks to enhance your visit. Guests can choose from craft beers, non-alcoholic options, a variety of wines, soft drinks, and prosecco. Whether you're craving a local craft beer, relaxing with a glass of wine, or opting for a refreshing soft drink, the main bar offers a welcoming atmosphere with options to suit every palate.

With a capacity of approximately 80 people, The Kings Hall Bar is an ideal venue for both intimate gatherings and larger events. Whether you're attending an event or simply soaking in the view, The Kings Hall Bar promises a memorable experience in the heart of Herne Bay.

THE HALL & STAGE

The Kings Hall offers a versatile space with a capacity just under 500 seated or 600 standing. Featuring one of the last sprung maple wood ballroom floors in the area and a fully functional professional stage, it provides a truly diverse setting.

The hall also boasts two pop up bars and two spotlight boxes.

The stage has seen artists such as Paul Young, Gary Delaney, Francis Rossie, Donny Osmond, Bad Manners, Skatronics as well as community theatre, craft fairs, dance competitions and much more.



KING'S HALL



FLOOR PLANS

STANDING GIGS / REHEARSALS >

THEATRE >

CABERET & THEATRE MIX >

BANQUET >

DANCE FLOOR / CABERET MIX >



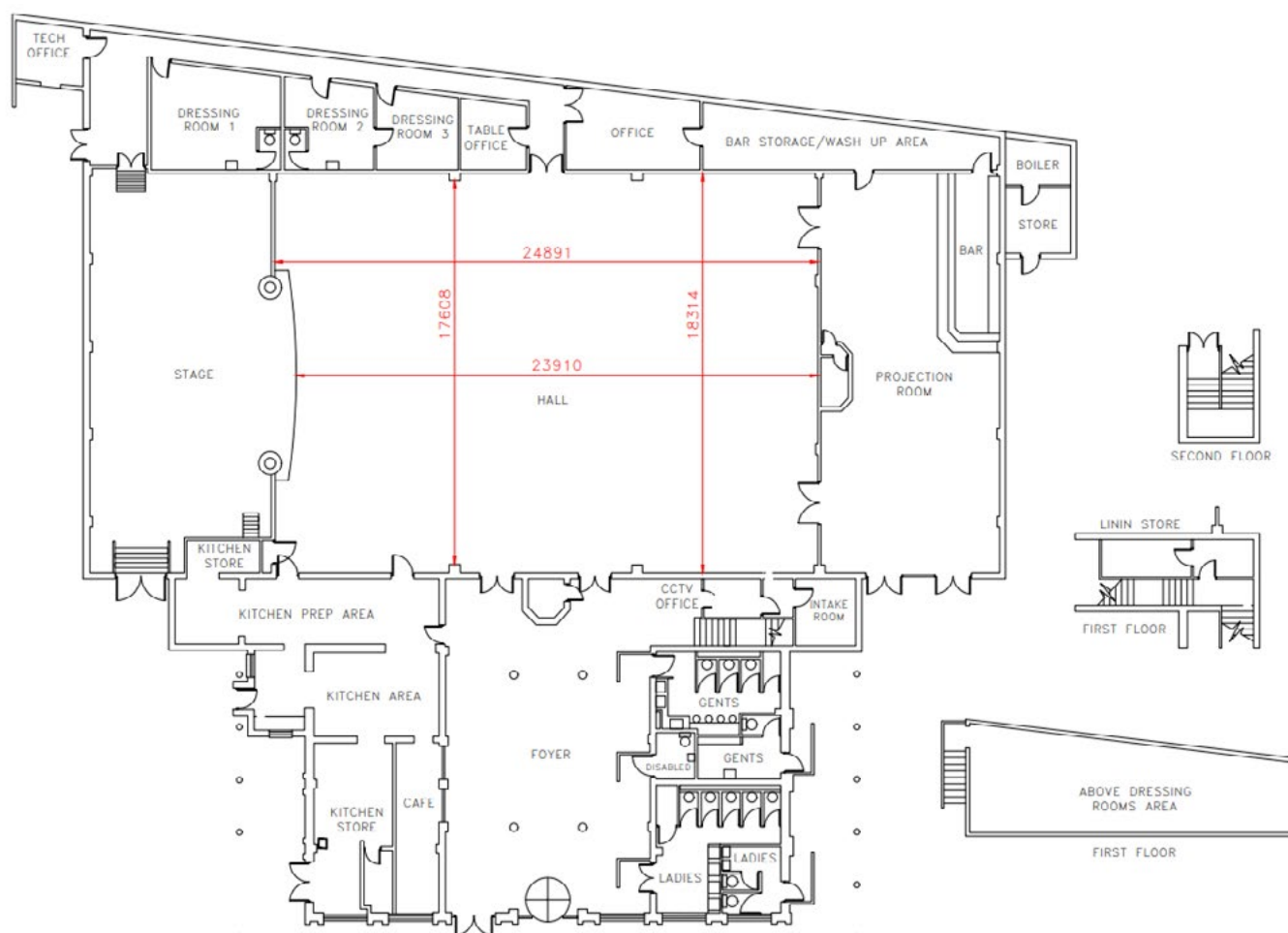

PLAN: STANDING GIGS / REHEARSALS

HALL LAYOUT

Plan: Standing Gigs / Rehearsals

Capacity: 600

Image for illustrative purposes only.

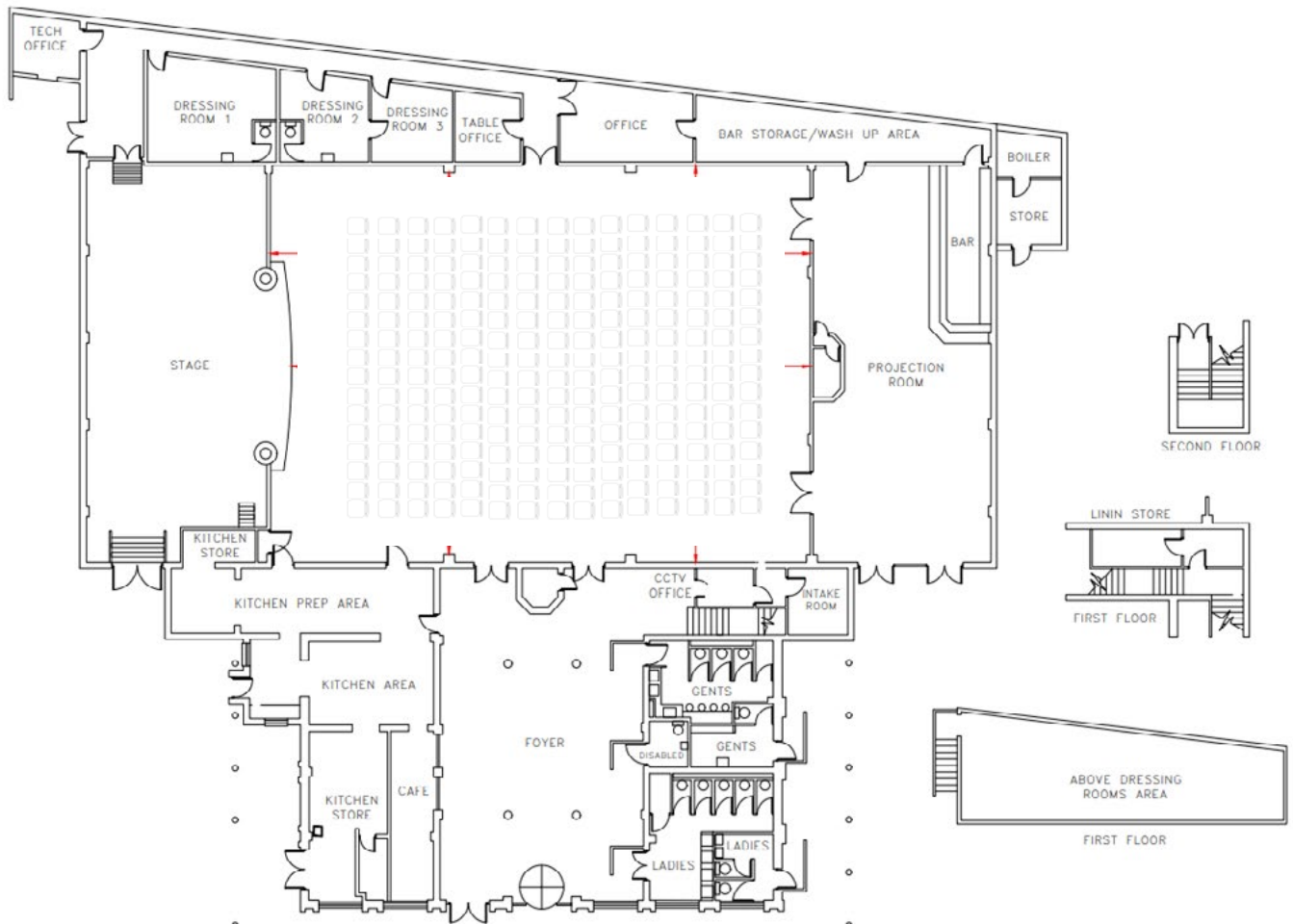

PLAN: THEATRE

HALL LAYOUT

Plan: Theatre

Capacity: 500

Image for illustrative purposes only.

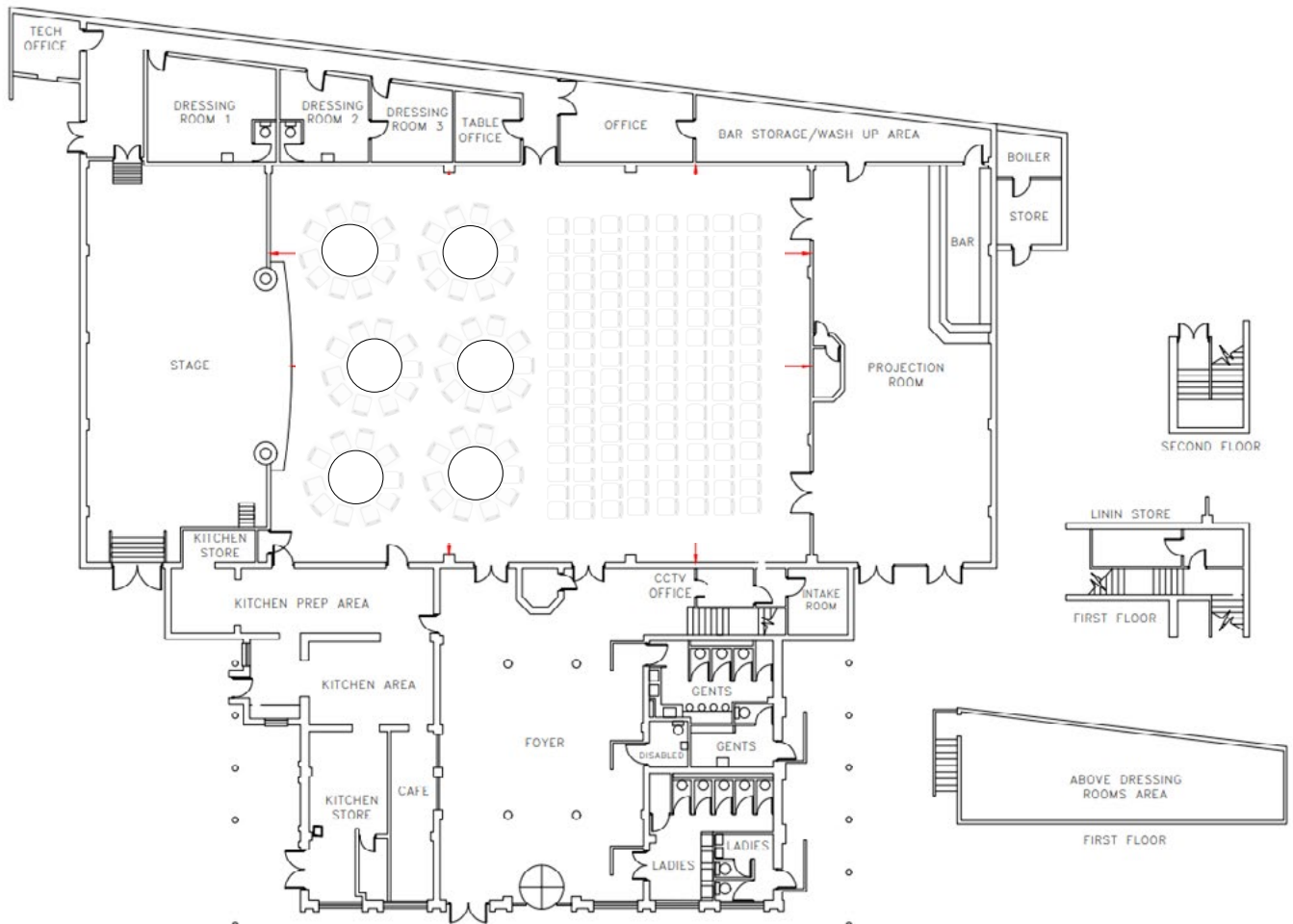

PLAN: CABERET & THEATRE MIX

HALL LAYOUT

Plan: Caberet & Theatre Mix

Capacity: 300-350

Image for illustrative purposes only.

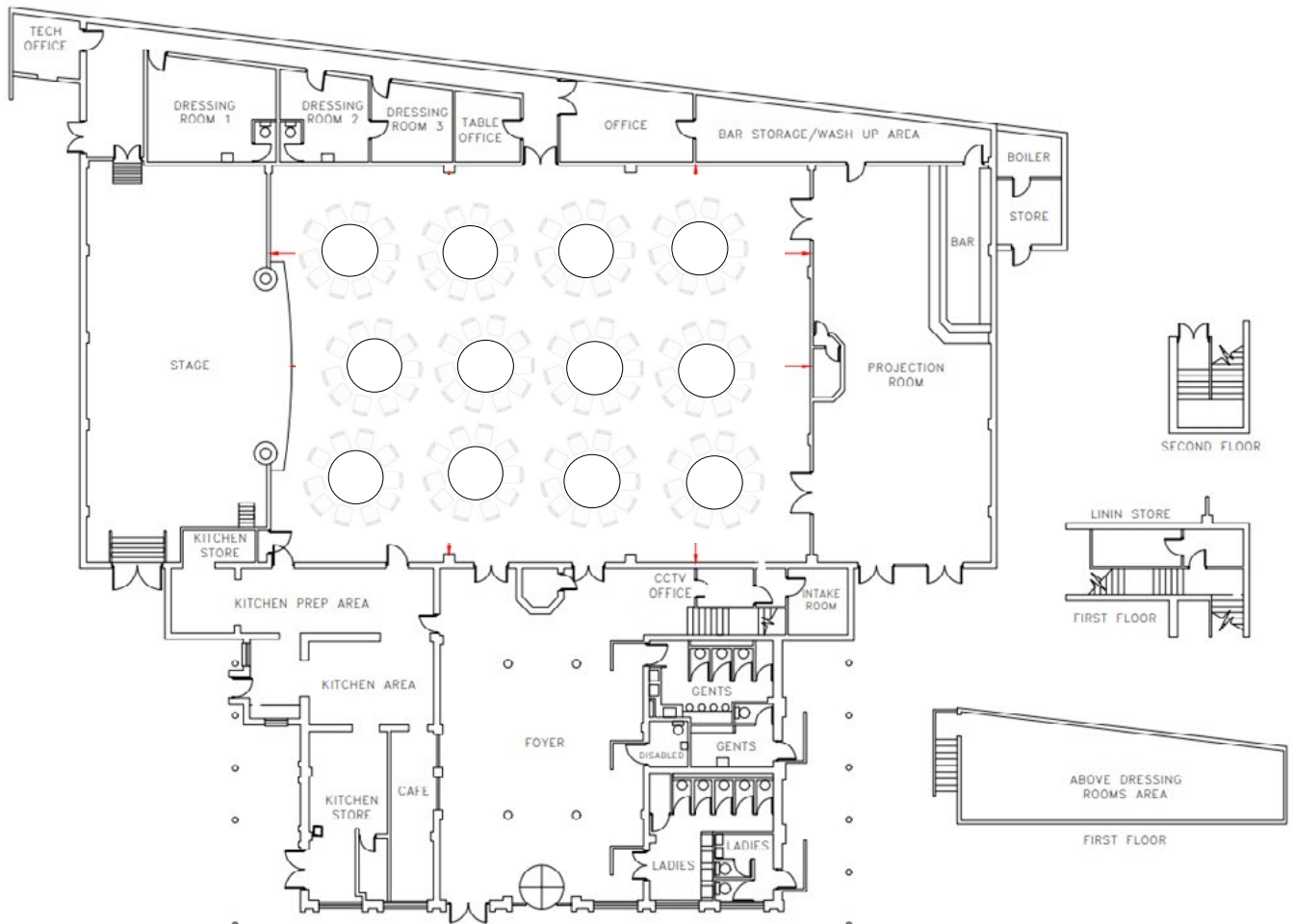

PLAN: BANQUET

HALL LAYOUT

Plan: Banquet

Capacity: 300 (30 Tables)

Image for illustrative purposes only.

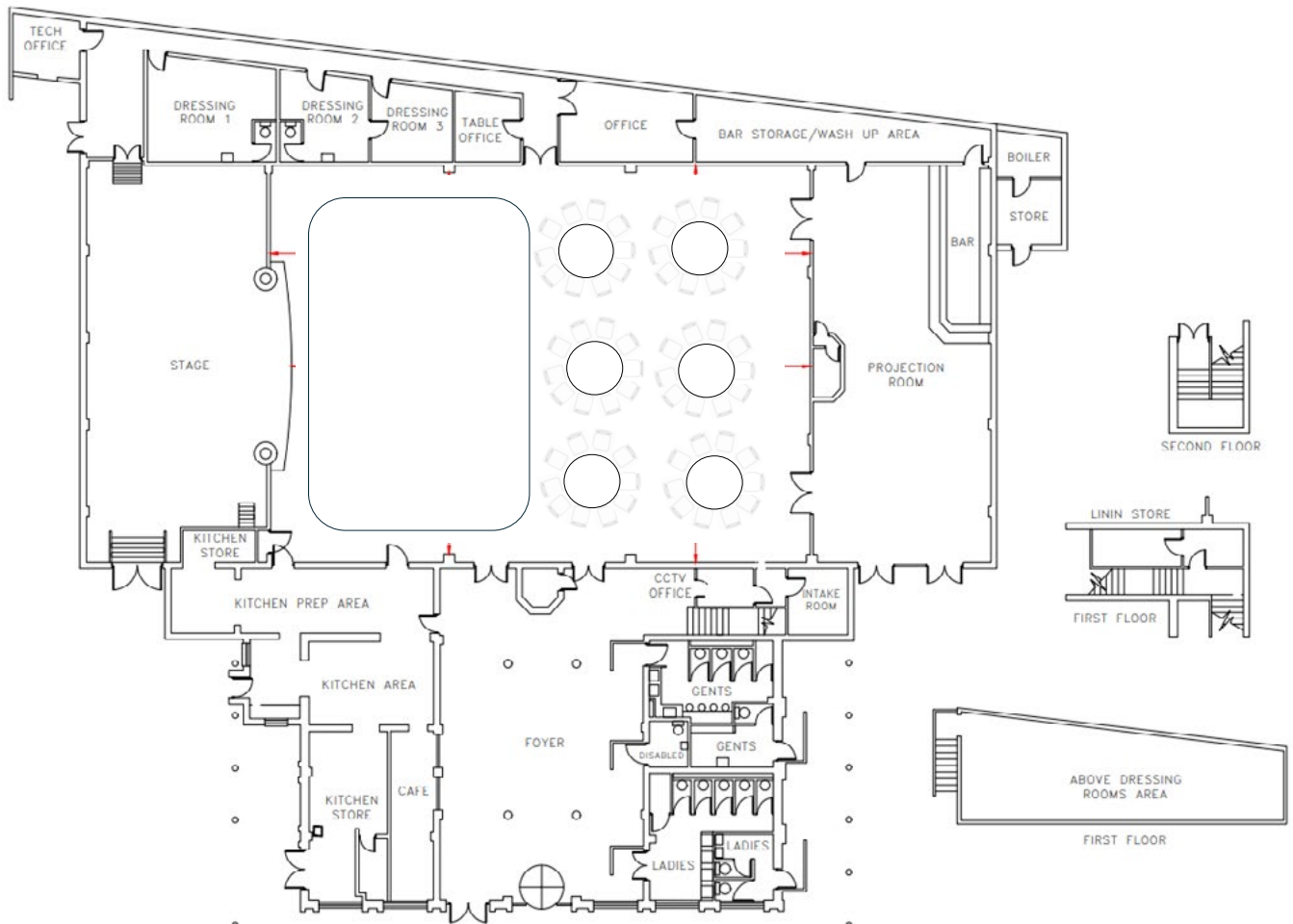

PLAN: DANCE FLOOR / CABERET MIX

HALL LAYOUT

Plan: Dance Floor / Caberet Mix

Capacity: 110 (tables & chairs) OR 200 (chairs only)

Image for illustrative purposes only.

KING'S HALL



TECHNICAL SPECIFICATION



CONTACT & LOCATION DETAILS

- The Kings Hall: 01227 374188
- Address: Beacon Hill, Herne Bay, CT6 6BA
- Technical Contact: Damon Oldacre: 07736 303 855 / Damon@Aura-Event.Services
- What3Words (Stage Loading Door): ///hosts.shaky.last

TECHNICAL DETAILS

Stage

- Proscenium: 7.54m wide x 3.9m high
Width: 9.9m Depth: 9m Floor: Partial rake, partial lino
- Access to auditorium: From Stage Left
- Flying system: No facilities
- Wing space: Stage Left: 5m wide x 8m deep (grand piano stored here)
- Stage Right: 3m wide x 8m deep Get in Stage Right: 2.3m wide x 2.7m high
6 steps up to stage level
- Orchestra Pit - No facilities

ARTISTS' ACCOMMODATION

All rooms six steps down from Stage Left level

- Room 1: maximum 20 persons (6 m x 4.4 m) Toilet and 2 sinks, 5 mirrors with lights
- Room 2: maximum 10 persons (4 m x 3.7 m) Toilet and 1 sink, 2 mirrors with lights
- Room 3: maximum 8 persons (3.4 m x 3.5 m)
- Green room: Tea & Coffee supplied
- Wardrobe: No facilities

STAGE INVENTORY

Power

- 1 x 63 Amp 3 Phase Cee Form located DSR
- 1 x 63 Amp Single Phase Cee Form located DSR

Cat 6 Tie Lines

- 4 x Shielded Cat 6 tie lines from rear of venue to stage (2 SL & 2 SR)

House tabs

- Red – Manual operation wheel to Stage Right

Tabs on tracks

- Hand line operation
- Overlap Tracks
- 2 sets – 8.6m wide x 4.55m high
- Red (1.5m upstage of house tabs)
- Black (in front of cyc)

Cyc. bar

- 25mm Conduit – operated hand winch Stage Left
- 48mm OD Stretching barrels to sides
- Full size white front projection cyc fitted

Legs

- 4 sets – 1.5m wide x 4.6m long – Black

Borders

- 5 – 9.9m wide x 1m deep – Black
- Operated hand winch Stage Left

Access Equipment

- 1 x 6 step A-Frame
- 1 x 10 step A-Frame
- 1 x 11 step A-Frame
- 1 x Zarges 14 step extendable combination ladder
- 1 x Genie AWP Powered Personnel Lift (for use in auditorium)

Piano

- 1 x Steinway Grand

Portable Rostra/Riser

- 750mm square units, linking plates
- 13 units 500mm high, 4 units 300mm high

Miscellaneous

- 4 x 12.5kg Stage Weights

LIGHTING INVENTORY

- 2 x Strand JTM Dimmer Racks providing 40 ways of dimming, 10 Amp circuits
- 1 x Strand 200 48 channel Lighting Board
- 4 x L/X Bars On Stage. Operated Stage Left via Worm drive Hand Winches, Max. UDL 230kg, Max 4.5m High. Patch at grid Height Stage Right
- 1 x FOH Bar 12 Circuit 10A – 8 Circuits paired
- 4 x ETC Source 4 fixed beam Profile (1 FOH, 3 on Stage)
- 8 x ETC Source 4 Junior zoom Profile (6 FOH, 2 on Stage)
- 4 x LDR Aria F1000 1k Fresnel
- 6 x Selecon 650w Fresnel
- 3 x PAR 64 floor cans
- 20 x PAR 64
- 2 x PAR 56

Note: Dimmer circuits are hard patched, ample time and discussion will be required to achieve a result other than basic.

SOUND INVENTORY

FOH

- Tie Lines
- Stage Left: 18 Send, 8 Returns
- Stage Right: 8 Send Leading to panel at rear of Auditorium.

Control Booth

- Raised Platform, 500mm floor height. Mixer on desktop and Playback mounted under

Mixer

- Yamaha LS9 32

Playback

- 1 x Denon CD Player
- 1 x Tascam Mini Disc Recorder

Speakers

- 4 x Martin Audio F15 - two either side of pros arch and two partway down the hall delayed)
- 2 x Mackie Powered Subwoofer
- QSC RMX Amplification

Foldback

- 4 x Martin Blackline XP12 Powered Loudspeakers/ Monitors
- 2 x Studiospares Loudspeakers/Monitors

Microphones and DI

- 3 x Behringer DI100 DI Box (Mono) Phantom Powered
- 1 x AKG D112 kick drum mic
- 1 x Sennheiser e602 kick drum mic
- 3 x Sennheiser e604 Clip-on drum Mic.
- 1 x AKG C451B pencil condenser
- 2 x SE Electronics SE1a condenser mic
- 1 x Sennheiser e609 cabinet/Percussion Mic
- 3 x Shure SM 57
- 3 x Shure SM 58

Stands

- 4 x Rat illuminated Orchestra Stands
- 2 x Speaker Stands
- 9 x Tall Boom Mic Stand
- 4 x Short Boom Mic Stand

Miscellaneous Equipment

- 2 x Behringer Shark
- Assorted Rack Gear (GEQ, FX, Processor etc)

COMMS INVENTORY

- F1 x Canford Tecpro MS721 2-Circuit Master Station
- 2 x Canford Tecpro BP111 Beltpack
- 3 x Single Muff Headset

VIDEO INVENTORY

- 1 x Hitachi 3000 Lumen Projector (Standard Lens)

THE KING'S HALL, HERNE BAY HIRE CHARGES

HIRE OPTIONS	NOTES	COMMERCIAL HIRE	REGISTERED CHARITIES
Week Hire	Max 7 days, Max 56 hours	£5,190	£3,800
Day (Mon - Thurs)	Max 8 hours, 8:30am – midnight	£1,190	£892
Day (Mon - Thurs) Dry Hire	Max 8 hours, 8:30am – midnight	£689	£540
Day (Fri, Sat, Sun)	Max 8 hours, 8:30am – midnight	£1,275	£935
Day (Fri, Sat, Sun) Dry Hire	Max 8 hours, 8:30am – midnight	£738	£590
Additional Hours/ Overtime (Mon - Sun)	8:30am – midnight	£80	£80
Additional Hours/ Overtime (Mon – Sun)	Before 8:30am and after midnight	£95	£95
Bar Only Hire	Max 8 hours, 8:30am – midnight	£937.50	£750

APRIL 2025 – MARCH 2026

- **All charges exclude VAT** which will be added at the prevailing rate (currently 20%).
- **PRS at a maximum rate of 4.2% of Gross Box Office income** will be applied to all music events.
- **Hire Schedule** and hire cost to be agreed at point of booking.
- A **20% deposit** is payable to confirm bookings.
- Front of House staff, there is a minimum staff call of 4 hours.
- The King's Hall does not operate split shifts. Charges per day will apply from the earliest opening time of the
- Hall to the latest closing time – inclusive.

ADDITIONAL CHARGES (IF APPLICABLE)

- **PRS** – charges for the performance of live music will be recharged to the hirer. Normally this is 4.2% Gross Box office income. Companies may licence productions with licence holders, in which case no charge will apply.
- **SIA Security staff** – if required – at the venue's discretion, booked by the venue and recharged at £30 +VAT per member of staff per hour.
- **Overtime** – Staff will monitor hours of use and apply overtime charges. If the agreed schedule is not adhered to, or if additional time is requested, the relevant hourly overtime rate will apply.
- **Event Cleaning** – Normal cleaning of the venue is included in the hire rates above. If additional cleaning is required after the event (e.g. to clean up excessive rubbish, food, remove gum, talcum, mud, set and props) then this will be recharged to the hirer at £146 +VAT per day.
- **Admin Charge** – All hires include five hours of administration support. Additional support will be charged at the standard overtime rate of £73 +VAT.
- **Foyer** – Digital advertisement is available on the Venue's advertisement screen for a flat fee of £80 +VAT.
- **E-shot** – Direct email marketing to The Kings Hall mailing list ins £30 for solus.
- **Table Dressing** – Includes black table clothes and table lamps at £12 +VAT per table

	STANDARD HIRE		REGISTERED CHARITIES	
Provision	Included	Additional Cost	Included	Additional Cost
Hall and bar areas	✓		✓	
Dance floor cleaning prior to event	✓		✓	
Staff for supervision and evacuation purposes	✓		✓	
Stage facilities for performance and technical equipment as listed on our tech specs	✓		✓	
Staffed Licensed bar	✓		✓	
Chairs and tables in stock	✓		✓	
Additional furniture, tablecloths, etc		✓		✓
Teas, coffees, refreshments from the bar		✓		✓
Marketing - Website listing, poster and flyer display	✓		✓	
Solus e shots, paid Facebook boosts etc		✓		✓
Technical staffing		✓		✓
Box Office services - free of charge to hirer for ticketed events	✓		✓	
Front of House/ Box Office / welcome staff for show nights		✓		✓

KING'S HALL



DOWNLOAD BOOKING FORM



DOWNLOAD TERMS & CONDITIONS



BEACON HALL, HERNE BAY
WWW.THEKINGSHALL.COM